

## Wind-Driven Eagle Eye instructions

Only use the Wind-driven unit in areas with sufficient wind. Use in combination with the motorised Eagle Eye unit for optimal results.

**Agriculture:** Place the unit in the centre of the area to be protected. The unit should be turning 1 meter above the crop. Add 10 FlashFlags for every Hectare of land.

The pipe may be fastened to a secondary pipe with a clamp or cable-ties. No bracket is needed in this case.

A Flat-bracket is used for flat surfaces and a Corner-bracket is used for roof-peaks.

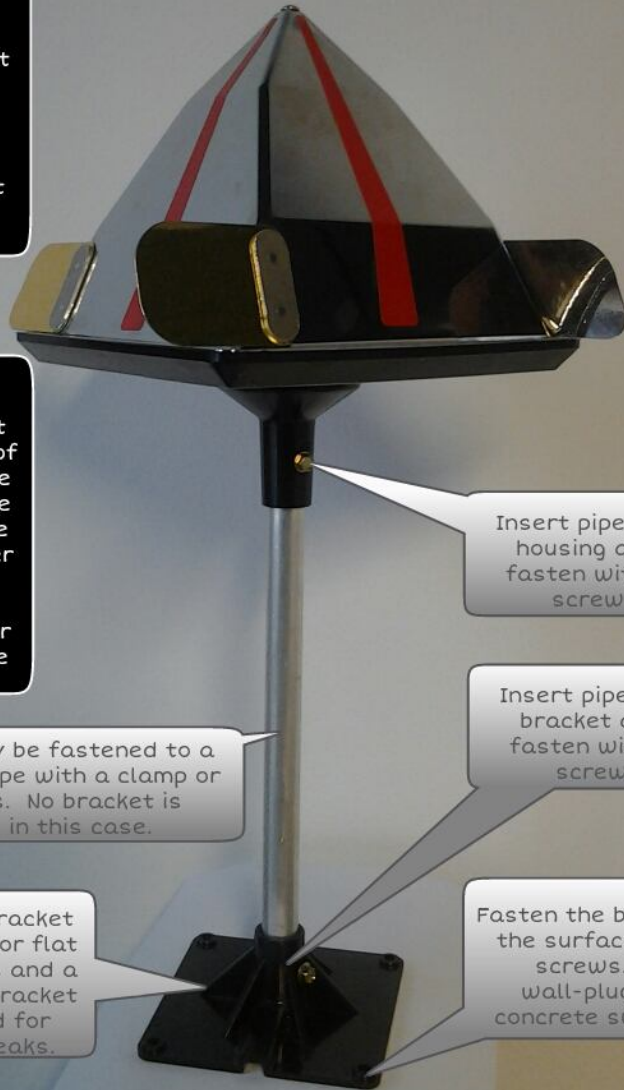

Insert pipe into housing and fasten with a screw

Insert pipe into bracket and fasten with a screw

Fasten the bracket to the surface with 4 screws. Use wall-plugs for concrete surfaces.

## Wind-Driven Eagle Eye instructions

Only use the Wind-driven unit in areas with sufficient wind. Use in combination with the motorised Eagle Eye unit for optimal results.

**Agriculture:** Place the unit in the centre of the area to be protected. The unit should be turning 1 meter above the crop. Add 10 FlashFlags for every Hectare of land.

The pipe may be fastened to a secondary pipe with a clamp or cable-ties. No bracket is needed in this case.

A Flat-bracket is used for flat surfaces and a Corner-bracket is used for roof-peaks.

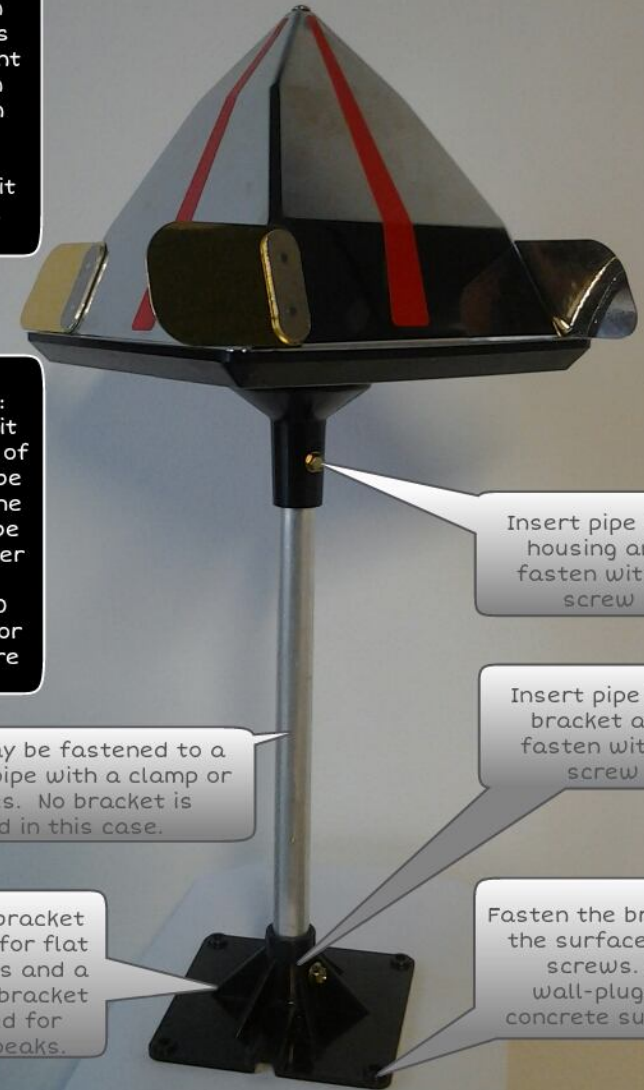

Insert pipe into housing and fasten with a screw

Insert pipe into bracket and fasten with a screw

Fasten the bracket to the surface with 4 screws. Use wall-plugs for concrete surfaces.